

L E N A B O Y

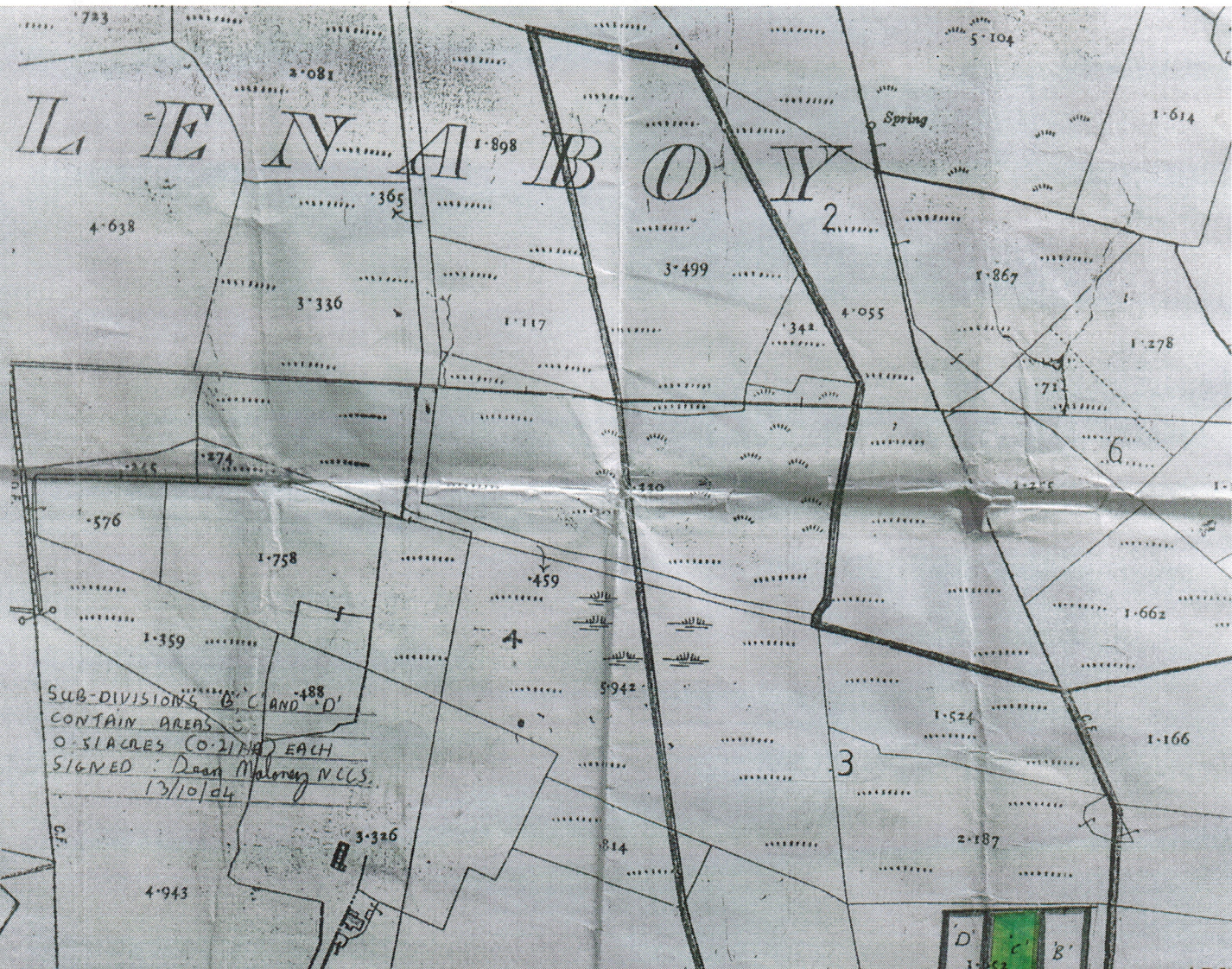

SUB-DIVISIONS C, C' AND 'D'
CONTAIN AREAS
OF SIACRES (0.2178) EACH
SIGNED: Daan Maloney N.L.S.
13/10/04

LANDREGISTRY

County GALWAY
Folio 4111 S. 2159

This map should be read in conjunction with the folio.
(Plan No. on 1st Page)

This Map does not show appurtenant or servient rights
It is not conclusive evidence as to the boundary or extent of
the land. (See Section 85 of the Registration of Title Act 1964)

Where a boundary has been transferred from a smaller
scale map, accuracy is limited to that of the smaller scale.

This map, subject to the provisions of the L.R. Rules, is
acceptable for subdivision purposes. 5/12/01

CERTIFIED TO BE A TRUE
COPY OF THE ORIGINAL RECORDS

